

Silver Series® 2-Flavor Cold Beverage System with LED Lighted Graphics

ITEM#

PROJECT

DATE



JDF-2S w/Lighted Graphics

(available with iced coffee or juice display)
Dimensions: 33.1"H x 10"W x 25.5"D
(84.1 cm H x 24.9 cm W x 64.8 cm D)

Features

Cold beverage dispenser with High Intensity® mixing delivers superior drinks consistently glass after glass

- LED lighted door graphics bring high visibility to front-of-house applications.
- One dispenser delivers both frozen and ambient products increasing profits by lowering costs.
- Drink consistency assured with the BUNN High Intensity® mixing technology.
- Pumps and mixes 2+1 to 11+1 concentrated beverages, including 4+1 high viscosity and 5+1 juices accurately and consistently.
- Quick dispense with 1.0 to 1.5 ounces (29.6 to 44.4 ml) per second flow rate.
- 7" cup clearance accommodates most juice containers.
- 8 lb. (3.6 kg) ice bank provides superior cold drink capacity.
- Advanced concentrate pump designed for easy setup, accuracy and durability.
- Modular dispense deck makes service fast and simple.
- Both push-button and single-size portion control in the same machine.
- Available with Iced Coffee or Juice display.
- Remote dispense switch kit model (juice display only) available for self-serve locations.
- Preventive maintenance kit: 39690.0000. 

For current specification sheets and other information, go to www.bunn.com.

Related Products

Easy Clear® EQHP-10
Product No. :39000.0004



Easy Clear® EQHP-10CRTG
Product No. :39000.1004

Ambient Conversion Kit
Product No.: 33699.0001
(one kit required per dispense station - photo shows 4-dispense station unit with one container and three ambient conversion kits)



Extended Drip Tray (JDF-2S)
Product No. :44015.1000
increases cup clearance to 10.25"
(grill not included, use existing grill or order 26801.0000 below)



Refillable Juice Container
Capacity: 1 Gallon
Product No.: 39302.0000



Remote Dispense Swith Retrofit Kit
(for Push and Hold button models only)
Product No.: 45536.1000

Replacement Grill fits Standard and Extended Drip Trays (JDF-2S)
Product No. :26801.0000

Model

Agency Listing

JDF-2S



Dimensions & Specifications

Model	Product #	Volts	Amps	Capacity	Cubic Measure	Shipping Weight	Cord Attached
JDF-2S, Lit Door <i>(juice display)</i>	37900.0008	120	4.5	4 (5 oz.) drinks/min*	10.3 ft ³	103 lbs.	Yes [†]
JDF-2S, Lit Door <i>(iced coffee display)</i>	37900.0009	120	4.5	4 (5 oz.) drinks/min*	10.3 ft ³	103 lbs.	Yes [†]
JDF-2S, Lit Door <i>(dual dispense - allows simultaneous dispense from both dispense heads, juice display)</i>	37900.0027	120	4.5	4 (5 oz.) drinks/min*	10.3 ft ³	103 lbs.	Yes [†]
JDF-2S, Lit Door <i>(includes remote dispense switch kit, juice display)</i>	37900.0044	120	4.5	4 (5 oz.) drinks/min*	10.3 ft ³	103 lbs.	Yes [†]

Refillable Juice Container Product No.: 39302.0000 Capacity: 1 Gallon (sold separately)

* 75°F (24°C) incoming water for 180 drinks without exceeding 41°F (5°C) finished drink temperature.

[†]Power cord (NEMA 5-15P) 15 Amp-120V machine only.

Electrical: Model requires 2-wire grounded service rated 120V, single phase, 60 Hz.

Plumbing: 20-100 psi (138 - 690 kPa). Machine supplied with 3/8" (0.95 cm) male fitting.

Refrigeration: R-134a refrigerant, 9 oz. (.28 kg), 8 lb. (3.6 kg) ice bank system

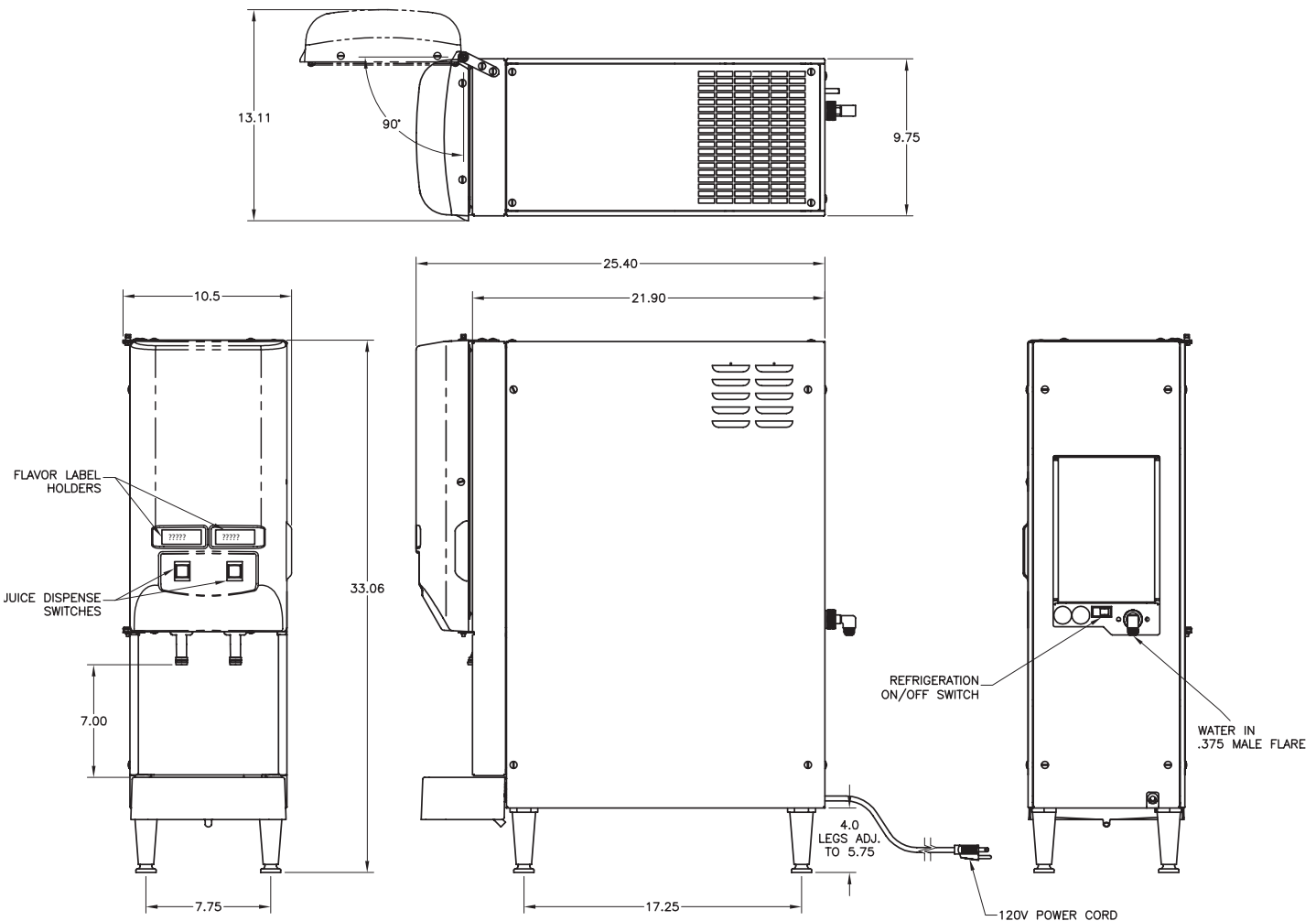

Bunn-O-Matic® Corporation - 1400 Stevenson Drive Springfield, Illinois 62703 • 800-637-8606 • 217-529-6601 • Fax 217-529-6644 • www.bunn.com

BUNN® practices continuous product research and improvement. We reserve the right to change specifications and product design without notice. Such revisions do not entitle the buyer to corresponding changes, improvements, additions or replacements for previously purchased equipment.

All dimensions shown in inches.